

牧草切碎收穫機 Trailed forage harvesters



FCT 960

FCT 1060

FCT 1360

FCT 1460

 **KENDING**

瑋洲企業有限公司

地址：台灣高雄市前鎮區武德街135巷24號

信件請寄：高雄市郵政信箱1394號

Tel：07-7169249 Fax：07-2134620

E-Mail: agri-machine@weizhou.com.tw

Line：weizohu1995 Skype：service450429 QQ：1467808036

Viber: +886972326392 WhatsApp: +886972326392 Wechat: walterhsu1995

<http://www.weizhou.com.tw/Agri-machine/i-forageharvester/index.htm>

Upper Cut



Upper Cut on forage harvesters

- The unique Upper Cut system cuts the crop at the shearbar and throws it directly into the chute. Thereby friction between the knives and rotor housing is avoided which means that the Upper Cut rotor provides a 25-50% increase in capacity compared to similar precision choppers with the same tractor.
- Upper Cut - Low fuel consumption.
- The FCT60 models feature a brand new cutting rotor, the result of much field testing. It is a new construction designed to a better blowing capacity.

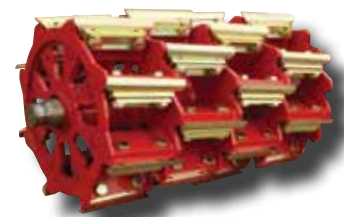
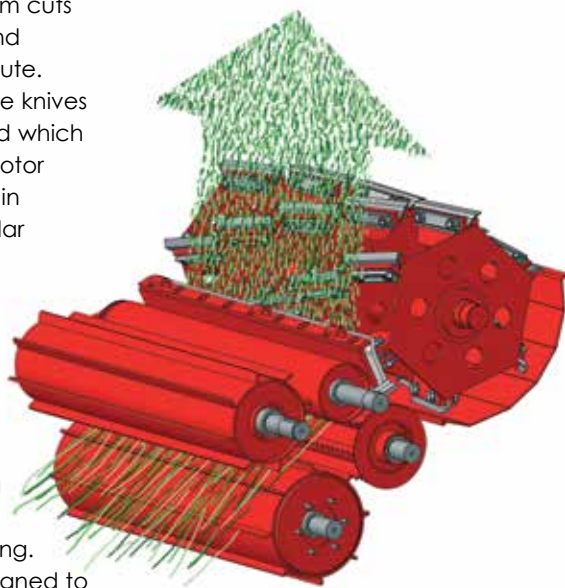

The cutting rotor in the FCT 60s is heavier and designed to draw in more air.



Knife sharpening is very simple. The direction of rotation of the rotor is changed and the dressing stone is pulled back and forth.



The Multi-knife system helps to keep costs to a minimum, it is only necessary to change a knife that covers $\frac{1}{4}$ of the rotor width.



It is very easy to get access to the chopping rotor, simply fold down the chute.

FCT 960 and FCT 1060



FCT 960 ProTec and FCT 1060 ProTec 2 Machines – many advantages

- ProTec means high protection. ProTec is a designation to FCT 960/1060 which explains that the machine is secured against possible foreign matter. In the transmission there is a friction clutch, which releases in case of high or sudden overload, for instance if a large object is on its way into the machine.
- The reverse system of the powerful type from the larger models is now standard on FCT 960/1060 ProTec. This implies transmission of sufficient power if it is necessary to reverse due to material being stuck.

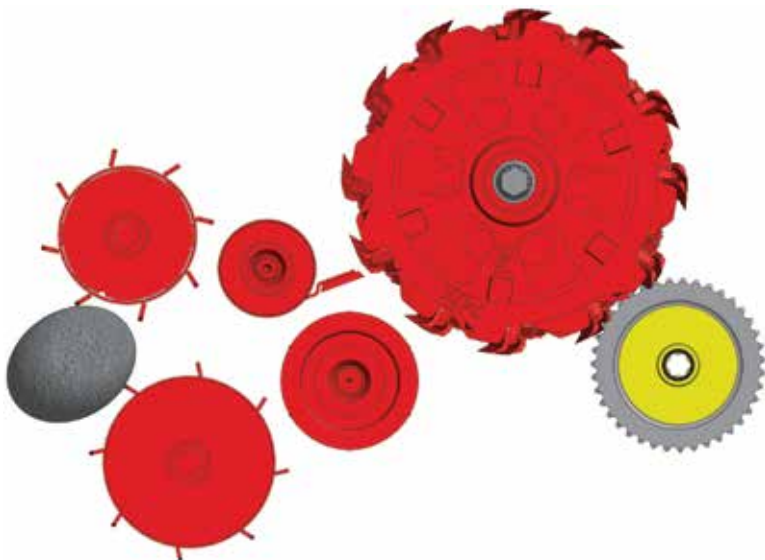

All gears and chains are hardened which gives a considerably longer life.



Reverse system is activated from the cabin.



ProTec means high protection.

Options for FCT 960/1060



Options for FCT 960/1060

Features:

- Machines with metal detector are all equipped with one set of feed rollers made of demagnetized material. In front of the rollers there is a magnetic field that will be actuated if a metal object gets near – this releases a stop pawl. The stop pawl will stop the feeding immediately, so that the metal object will not reach the chopping rotor.
- The machine is equipped with a very strong bevel gearbox which allows transmission of great power.
- Chute extension gives a better loading height in connection with side-loading.
- The FCT 1060 can be equipped with a 1.80 m or 2.10 m pick-up.

Benefits:

- Thereby you protect not only your machine but also your cows!
- No loss of power to keep up the capacity and thereby keep the low fuel consumption.
- Easier to operate and fill up the wagon, thereby increased efficiency.
- No loss of crop if the swath is a little uneven in the driving direction.



Metal detector (option FCT 1060)



Strong bevel gearbox



No loss of crop if the swath is a little uneven in the driving direction.



Chute extension FCT 960/1060

Easy operation with only one controller

Options

Electro hydraulic control box for FCT 1060.

Reversing of feed in and pick-up.

Turn on the feed in and pick-up

Control of deflector

Lowering of pick-up

Turning the chute

Hydraulic control of the drawbar

The diagram shows a red electro hydraulic control box for the FCT 1060. It features a central joystick, a red button on the left, and a toggle switch in the middle. Yellow lines connect these controls to circular inset images showing the corresponding machine functions: reversing feed in and pick-up, turning on feed in and pick-up, controlling the deflector, lowering the pick-up, turning the chute, and hydraulic control of the drawbar. The box has the SIF logo on the right side.



Electrical control box for FCT 960.



Control of deflector



Turning the chute

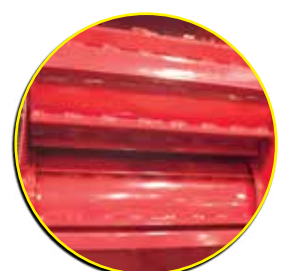

Reversing of feed in and pick-up.

FCT 1460 Standard with metal detector

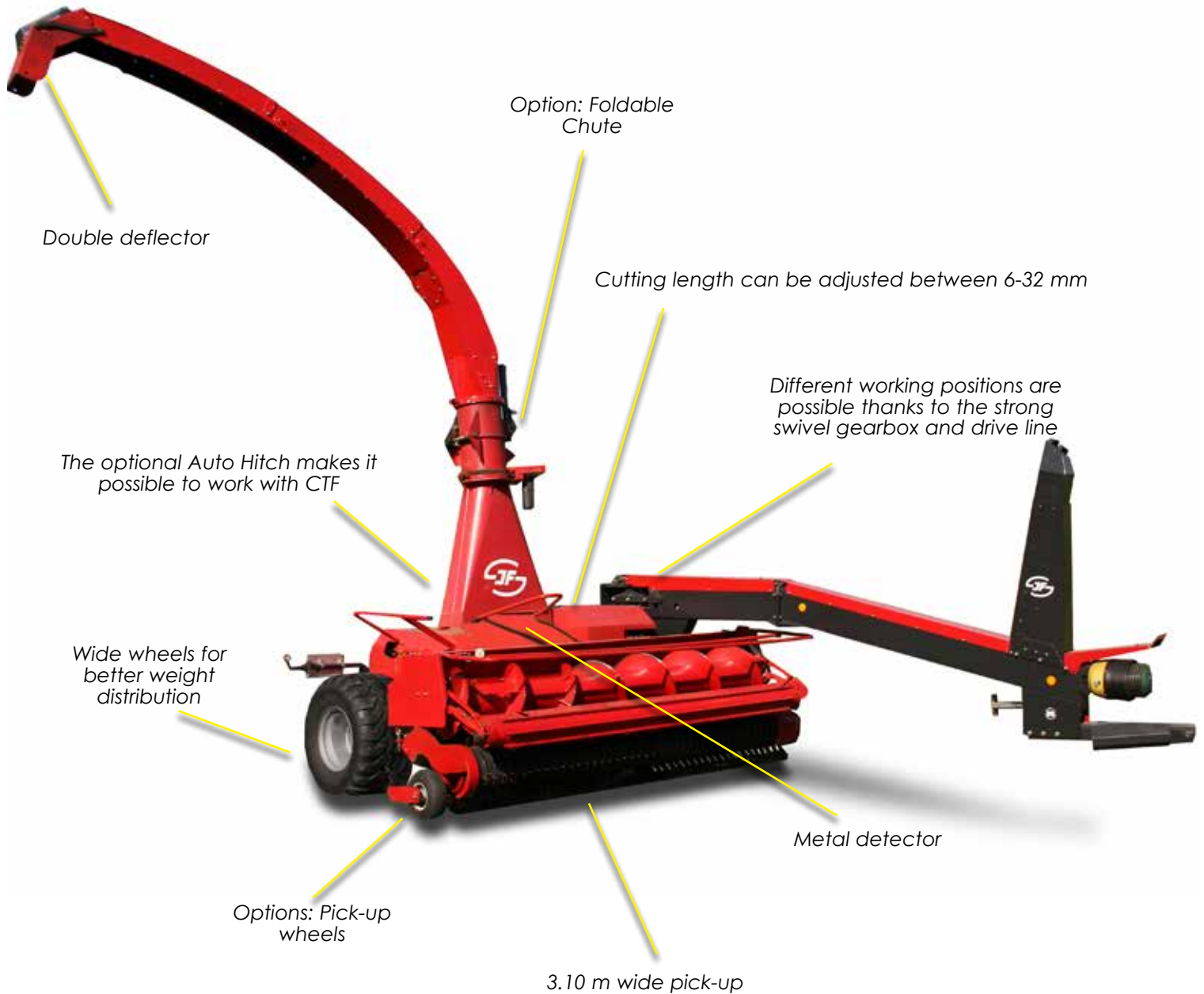

FCT 1360/1460



FCT 1360 and 1460 are JF's latest high-capacity forage harvesters.

These machines have a very strong but simple transmission and a very powerful feed intake. The result is a forage harvester with minimum maintenance and few repairs.

Features:

- The FCT 1360 has a drive shaft and a gearbox driven feed intake.
- Feed intake width is increased by 20% compared to FCT 1060, it means you get the best obtained result and optimal utilization of the 5-row cutting rotor which is standard on FCT 1360 and 1460.
- Wide pick-up of 3.10 m
- The pick-up roller crop press gives a regular flow through the feed intake area ahead of the rotor. Blockages are minimized and a regular crop delivery from the chute is obtained.

Benefits:

- The power is distributed to the feed rollers by PTO shafts which require less daily maintenance and power loss.
- This working width enables it to pick up a swath in full width after e.g. the biggest rotary rake or the GXT with collector.
- Ensures an even optimal flow and thereby increased capacity.



Drive shaft driven feed intake

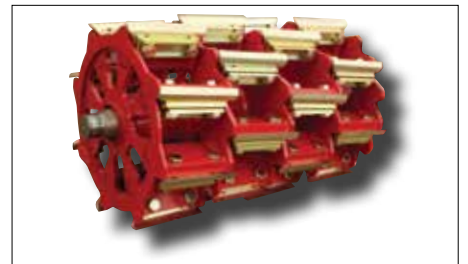

5-row cutting rotor



Wide pick-up roller

FCT 1360/1460



Electro hydraulic controller.

FCT 1360 and 1460 are fully controlled by electro hydraulic functions. Only 1 DA oil outlet is required to operate the machines:

- Control of drawbar
- Reverse the feed roller direction
- Turning the chute
- Control of chute double deflector
- Auto Hitch (Option)

Features:

- The feed intake and the 5-row cutting rotor are similar to FCT 1360. The difference is the feed roller transmission on FCT 1460 which is newly developed to resist the big challenge if foreign objects are stopping the transmission. Further it has more cutting length options. See specifications.

Benefits:

- You protect not only your machine but also the cows!



Reliable gearbox on FCT 1460

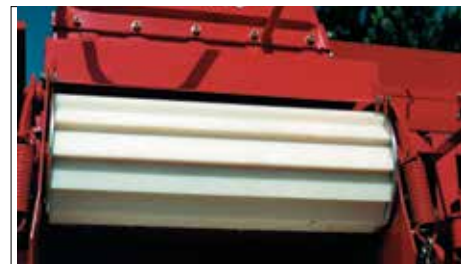

Metal detector.

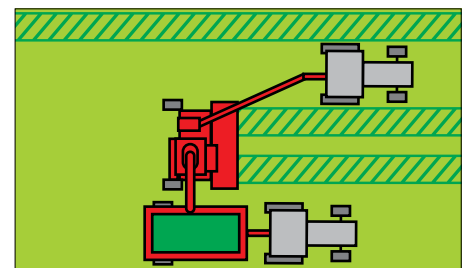

Off-set

The precision chopper works offset. The pick-up is outside the width of the tractor. This technique is ideal for very wide swaths, or after asymmetric swaths. This position is also ideal for sideloading, and you have a good overview.

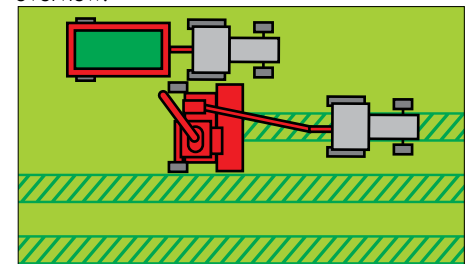

In-line

The precision chopper is completely in-line with the tractor and the distance between the tractors is very small. This driving technique gives benefits in areas where CTF is becoming increasingly popular, to spare the field for driving e.g. by trailing wagon.

Options



	Working side A	Transport B
960 Basis	3.4 m	3.75 m
960 Parallel	3.8 m	4.0 m
1060 Basis	3.8 m	4.0 m
1060 Parallel	4.0 m	4.4 m
1060 Foldable	4.7 m	3.7 m
Extension for chute (equipment)	30 cm	

	Working side A	Transport B
1360 Basis	3.65 m	3.8 m
1360 Parallel	4.05 m	4.4 m
1360 Foldable	5.05 m	3.8 m
1460 Basis	3.7 m	3.8 m
1460 Parallel	4.1 m	4.4 m
1460 Foldable	5.1 m	3.8 m
Extension for chute (equipment)	30 cm	



Connection and disconnection of trailer
The automatic trailer pick up hitch is hydraulically released with the comfortable joystick. All FCT machines can be equipped with Auto Hitch.



For more ripe maize we recommend a special serrated shearbar which crushes the maize kernels. Furthermore it is possible to obtain cutting lengths of 6 and 12 mm. 2-row maize unit is available for 960/1060 and 3-row for 1360.

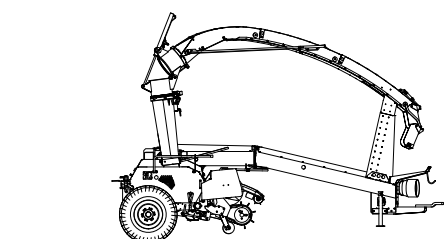
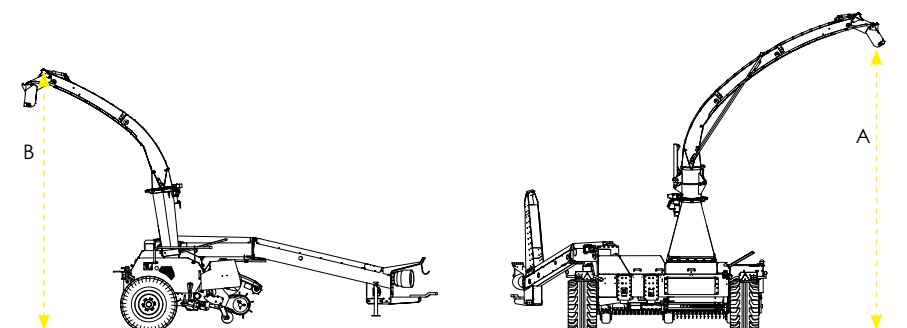

Folding chute

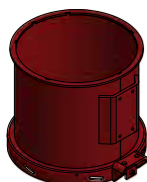

Extension for chute



For direct harvesting of grass and whole crop or the like a 2.4 m disc cutter bar is available. This cutter bar allows you to harvest almost ripe grain crops with nearly no waste of grains. Only suitable for FCT 960/1060.

Technical data



	FCT 960	FCT 1060
Tractor, min. (kW/HP)	88/120	88/120
Tractor, max. (kW/HP)	103/140	140/190
PTO-type, standard	1 3/8" - 6 splines	1 3/8" - 21 splines
PTO (RPM)	540/1000	1000
Rotor width	720 mm	720 mm
Number of knives	24/32	24/32
Cutting length, theoretical (mm)	8-16-(32)	8-16-(32)
Transport width (m)	2,80	3,30
Pick-up, m.	1,80	2,10
Cutting unit (m)	2,40	2,40
Maize unit	2-row	2-row
Metal detector	-	Option
Wheel standard	14/65x16	14/65x16
Reverse mechanism	Electrical	Hydraulic
Oil outlets	1 SA	1 DA
Weight (with pick-up)	2020	2300

	FCT 1360	FCT 1460
Tractor, min. (kW/HP)	103/140	147/200
Tractor, max. (kW/HP)	165/225	206/280
PTO-type, standard	1 3/4 - 20 splines	1 3/4 - 20 splines
PTO (RPM)	1000	1000
Rotor width	900 mm	900 mm
Number of knives	40	40
Cutting length, theoretical (mm)	7-15-(30)	6-8-12-16-(32)
Transport width (m)	3,53	3,57
Pick-up (m)	3,10	3,10
Maize unit	3-row	-
Metal detector	-	Standard
Wheel standard	19/45x17	500/50-17
Reverse mechanism	Hydraulic	Hydraulic
Oil outlets	1 DA	1 DA
Weight (with pick-up)	3600	3750